

beac. by
80%
1/2 or
whole st.
more

*are often
flabby
than we wish,
certainly more than their desc.
counterparts*

rec.

Handwritten guitar chord diagrams on a grid. The diagrams are arranged in rows and columns, with some containing red dots and others blue dots. The diagrams are labeled with chord names and numbers:

- Row 1: 6 A7#9+, 5 Dm9b5, 4 G7#9+, 5 C/9, 5 A7+, 5 Dm7b5, 8 G13b9
- Row 2: 8 G7, 5 E7#9, 5 iim9b5, 3 D7, 9 G7, 11 E7#11, 12 Am9, 9 D7#9+
- Row 3: 7 G7, 7 E7#9, 10 A9, 10 D7, 10 G7, 11 G7#9+, 12 A9/11, 15 D13b9, 14 G6/9, 11 E7#9+
- Row 4: 8 A9, 9 D7#9

The diagrams are arranged in a grid of approximately 10 columns and 7 rows. The first row contains 10 diagrams, the second row contains 10 diagrams, the third row contains 10 diagrams, the fourth row contains 2 diagrams, and the remaining rows (5-7) contain 10 empty diagrams each.

Handwritten guitar chord diagrams for the right hand, organized in a grid. Each diagram shows a 6-string guitar fretboard with dots indicating finger positions. The diagrams are labeled with chord names and numbers (1-10) indicating the fret.

Chord names and fret numbers shown include:

- A^b/9 (1)
- F7⁺ (1)
- B^b7^b9 I (3)
- E^b7 (4)
- A^b7 (4)
- F7^b9⁺ (4)
- B^b9 (4)
- E7^b9 (5)
- D9 (5)
- B7⁺ (5)
- E^b11 (5)
- A^b9 (5)
- F7^b9 (5)
- B^b7^b9 II (6)
- E^b7⁺ (6)
- A^b7 (6)
- F7^b9⁺ (6)
- B^b9 (6)
- E^b9 (6)
- D9 (6)
- B7⁺ (6)
- E^b11 (6)
- A^b9 (6)
- F7^b9 (6)
- A^b7 (7)
- F7^b9⁺ (7)
- B^b9 (7)
- E^b9 (7)
- D9 (7)
- B7⁺ (7)
- E^b11 (7)
- A^b9 (7)
- F7^b9 (7)
- A^b7 (8)
- F7^b9⁺ (8)
- B^b9 (8)
- E^b9 (8)
- D9 (8)
- B7⁺ (8)
- E^b11 (8)
- A^b9 (8)
- F7^b9 (8)
- A^b7 (9)
- F7^b9⁺ (9)
- B^b9 (9)
- E^b9 (9)
- D9 (9)
- B7⁺ (9)
- E^b11 (9)
- A^b9 (9)
- F7^b9 (9)
- A^b7 (10)
- F7^b9⁺ (10)
- B^b9 (10)
- E^b9 (10)
- D9 (10)
- B7⁺ (10)
- E^b11 (10)
- A^b9 (10)
- F7^b9 (10)

Other notes and markings include:

- 2 3 4 1 3
- D^b11/6#11
- G11
- C7
- A7^b9
- D7#9
- G13^b9
- C6/9
- A7⁺
- D9
- G⁺
- C7
- rt. hand*
- A7^b9⁺
- D7⁺9
- G⁺

A grid of 10 empty guitar fretboard diagrams, arranged in 5 rows and 2 columns, intended for practice or additional chord diagrams.

12-28-92

III⁷ VI⁷ II⁷ V⁷

5 F A⁰ / D7^{b9} G⁰

5 A⁰ D7^{b9} G⁰ 7 C7^{#9} F⁶

8 A-11^{b5} D7^{#9} G⁰ 8 G7^{b9} F⁶

A grid of 10 columns and 10 rows of empty guitar chord diagrams for practice.

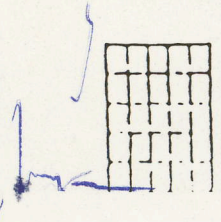

Handwritten guitar chord diagrams for various chords, including D^b13^b9 , G^b6 , $G^b6/9$, and D^b13^b9 . The diagrams are arranged in a grid with handwritten numbers (1-13) and some 'x' marks indicating muted strings. A blue line connects several diagrams, possibly indicating a sequence or a specific fingering path.

A grid of empty guitar chord diagrams for practice. The grid consists of 10 columns and 7 rows of empty 6-string fretboard diagrams.

13^b9 study Ted, I know, Key of G^b7